

Home Depot # 279.00 ^{2 Window}

35 3/4 X 41 1/4

Double Hung

2 windows
558.00

American Craftsman

from
willy

BILL TO:

SHIP TO:

TOWN OF ARLINGTON

ARLINGTON, VT 05250

| QUOTE # | STATUS | CUSTOMER PO# | DATE QUOTED |
|--------------|--------|---------------|-----------------------|
| 802593 | None | | 5/15/2026 12:56:42 PM |
| QUOTED BY | TERMS | PROJECT NAME | QUOTE NAME |
| Pete Duffany | | REC PARK BLDG | TOWN OF ARLINGTON |

| LINE # | QTY | SUB-LINES |
|--------|-----|-----------|
| 100 | 2 | 2 |

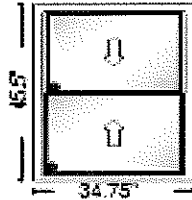

| LINE # | DESCRIPTION | QTY | NET PRICE | EXTD. PRICE |
|--------|-------------|-----|-----------|-------------|
| 100-1 | | 2 | \$505.67 | \$1,011.34 |

Walcott New Construction Double Hung
34.75 X 45.5 Unit Size, White, Insul Low-E & Argon
Tempered, 29.875 X 16.75 Clear Opening, 3.475 SQFT,
White Dual Lock, No Window Opening Control Device,
White Standard Tilt Latch, Insert White Full Screen Shipped
Loose
w/Nailing Flange, w/J Channel Cover, No Exterior Casing
Unit 1: UFactor: 0.29, SHG: 0.29, VLT: 0.55, CR: 58

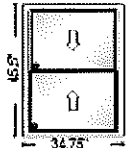

Mathews Brothers' Windows specified with Tempered Glass cannot be canceled or modified once an order is placed. There will be no grace period provided for Windows specified with Tempered Glass as they will enter into a production schedule immediately. Please review the specifications for this Window with Tempered Glass carefully to ensure they are correct prior to ordering.

Opening: 35.25" X 46"
O.S.M.: 34.75" X 45.5"

Tag: None Assigned

| | | | |
|------------------|---------------|---------------------|-----------------------|
| QUOTE # | STATUS | CUSTOMER PO# | DATE QUOTED |
| 802593 | None | | 5/15/2026 12:56:42 PM |
| QUOTED BY | TERMS | PROJECT NAME | QUOTE NAME |
| Pete Duffany | | REC PARK BLDG | TOWN OF ARLINGTON |

| LINE # | DESCRIPTION | QTY | NET PRICE | EXTD. PRICE |
|--------|-------------|-----|-----------|-------------|
| 100-2 | Screen1 | 2 | \$0.00 | \$0.00 |

Walcott Double Hung Insert Full Screen Shipped Loose
Window Unit Size: 34.75 X 45.5
Screen Color: White

Opening: 0" X 0"
O.S.M.:

Tag: None Assigned

| LINE # | DESCRIPTION | QTY | NET PRICE | EXTD. PRICE |
|--------|-------------|-----|-----------|-------------|
| 200-1 | | 2 | \$567.54 | \$1,135.08 |

Walcott New Construction Direct Glaze Garage Transom
TR9614, White, Insul Low-E & Argon Tempered, Unrated
w/Nailing Flange, w/J Channel Cover, No Exterior Casing
Unit 1: UFactor: 0.29, SHG: 0.31, VLT: 0.56, CR: 58



4 Week Lead Time for Oversized Glass

Mathews Brothers' Windows specified with Tempered Glass cannot be canceled or modified once an order is placed. There will be no grace period provided for Windows specified with Tempered Glass as they will enter into a production schedule immediately. Please review the specifications for this Window with Tempered Glass carefully to ensure they are correct prior to ordering.

Opening: 96" X 14"
O.S.M.: 95.5" X 13.5"

Tag: None Assigned

| | | | |
|------------------|---------------|---------------------|-----------------------|
| QUOTE # | STATUS | CUSTOMER PO# | DATE QUOTED |
| 802593 | None | | 5/15/2026 12:56:42 PM |
| QUOTED BY | TERMS | PROJECT NAME | QUOTE NAME |
| Pete Duffany | | REC PARK BLDG | TOWN OF ARLINGTON |

Proposal is valid for 30 days from the issue date.

All materials must be picked up or delivered within 60 days of the invoice date. Items held beyond this period will incur a minimum storage fee of \$50.00 per month, billed monthly and payable prior to release. Materials not picked up within 180 days may be considered abandoned and subject to resale or disposal without further notice. Any deposit or payment made will be forfeited.

| | |
|-------------------|------------|
| SUB-TOTAL: | \$2,146.42 |
| LABOR: | \$0.00 |
| FREIGHT: | \$0.00 |
| SALES TAX: | \$0.00 |

Verification of all quantities, specifications and sizing is the responsibility of the owner, builder, architect.

Order will not be placed until a signed copy of this proposal is returned to r.k. Miles, Inc.

ALL SPECIAL ORDERS ARE NON-RETURNABLE, NO EXCEPTIONS.

For cash account customers, special orders that are less than \$2,500.00 require payment in full at time of purchase. For orders in excess \$2,500, a deposit of 60% is required when the order is placed, and the remaining balances will be due when orders are received by r.k. Miles, Inc. Deposits are payable by cash, check, debit, or credit card. Charge account customers will be handled on a case-by-case basis.

Price increases outside of our control such as tariffs, pandemics, regulatory changes, material shortages, market volatility, etc. may affect pricing on quotes/estimates.

Requested changes or cancellations may not be accepted and, if approved, may result in additional charges.

| | |
|---------------|------------|
| TOTAL: | \$2,146.42 |
|---------------|------------|

CUSTOMER SIGNATURE _____ DATE _____

We appreciate the opportunity to provide you with this quote!



Window & Door Schedule Report

PROJECT NAME: REC PARK BLDG

Quote #: 802593

Planned Ship Date: Planned Ship Date Not Set

Quote Date: 5/15/2026

| | |
|--|---|
| Dealer: r k Miles 618 Depot St. PO Box 1125 Manchester Center VT 05255 Phone: _____ Fax: _____ | Customer: r k Miles - Manchester Center 450 Natural Form Way Manchester VT 05255 Phone: _____ Fax: _____ |
|--|---|

| LINE # | DESCRIPTION | QTY | Location / Room | Unit Size (WxH) | Rough Opening (WxH) |
|--------|---|-----|-----------------|-----------------|---------------------|
| 100-1 | Walcott New Construction Double Hung 34.75 X 45.5 Unit Size, White, Insul Low-E & Argon Tempered, 29.875 X 16.75 Clear Opening, 3.475 SQFT, White Dual Lock, No Window Opening Control Device, White Standard Tilt Latch, Insert White Full Screen Slipped Loose | 2 | None Assigned | 34.75" X 45.5" | 35.25" X 46" |
| 100-2 | Walcott Double Hung Insert Full Screen Slipped Loose Window Unit Size: 34.75 X 45.5 Screen Color: White | 2 | None Assigned | | 0" X 0" |
| 200-1 | Walcott New Construction Direct Glaze Garage Transom TR9614, White, Insul Low-E & Argon Tempered, Unrated w/Nailing Flange, w/J Channel Cover, No Exterior Casing Unit 1: UFactor: 0.29, SHG: 0.31, VLT: 0.56, CR: 58 | 2 | None Assigned | 95.5" X 13.5" | 96" X 14" |



Quote
 Quo #: 570784

 Route: AN85
 Page: 1 of 1

 Quote: 05/15/26

 Entd By: WBRE
Printed
 Date: 05/15/26
 Time: 01:20 PM

TOWN OF ARLINGTON
 ARLINGTON, VT 05250
 ATTN: WILLY KNIGHT

Ship To:
 R.K. MILES, INC. (MANCHESTER)
 450 NATURAL FORM WAY
 LMC DEALER #199100
 MANCHESTER CENTER VT 05255
 (802) 362-1952

| | | |
|-------------------------------|------------------------|------------------------------|
| Ordered by: PETE D | In: WARREN BRENENSTUHL | <u>Customer Instructions</u> |
| Your Order: TOWN OF ARLINGTON | Out: JOE CAVALIERI | |

CURRENT LEAD TIME IS 2 WEEKS
 HARDWARE NOT INCLUDED !!!!!!!!!!!!!!!

| Description | Quantity | U/M | Unit Price | Net Extended | Line # |
|---|----------|-----|------------|--------------|----------|
| 3/0X6/8 CP-10 FLUSH COMMERCIAL FIBERGLASS LHIS, COMPOSITE PRIMED 6-9/16 JAMB, BRNZ W/S, 1/2" X 8" ALUM SADDLE ADA, W/SWEEP, 4-1/2 USP PRIMED BALL BEARING SQ HGS, NO CSG, SGLE BORE, 2-3/4 BKST, 161 PREP, 1-1/8" WIDE EDGE, (STD) STRIKE JAMB PREP | 1.00 | EA | | | \$978.00 |
| 3/0X6/8 CP-10 FLUSH COMMERCIAL FIBERGLASS RHIS, COMPOSITE PRIMED 6-9/16 JAMB, BRNZ W/S, 1/2" X 8" ALUM SADDLE ADA, W/SWEEP, 4-1/2 USP PRIMED BALL BEARING SQ HGS, NO CSG, SGLE BORE, 2-3/4 BKST, 161 PREP, 1-1/8" WIDE EDGE, (STD) STRIKE JAMB PREP | 1.00 | EA | | | \$978.00 |

\$1,956.00
 TAX EXCLUDED !!!!!!!

Acceptance of Proposal

Proposal is valid for 30 days from the issue date. All materials must be picked up or delivered within 60 days of the invoice date. Items held beyond this period will incur a minimum storage fee of \$50.00 per month, billed monthly and payable prior to release. Materials not picked up within 180 days may be considered abandoned and subject to resale or disposal without further notice. Any deposit or payment made will be forfeited. Verification of all quantities, specifications and sizing is the responsibility of the owner, builder, architect. Order will not be placed until a signed copy of this proposal is returned to r.k. Miles, Inc. ALL SPECIAL ORDERS ARE NON-RETURNABLE, NO EXCEPTIONS. For cash account customers, special orders that are less than \$2,500.00 require payment in full at time of purchase. For orders in excess of \$2,500, a deposit of 60% is required when the order is placed, and the remaining balances will be due when orders are received by r.k. Miles, Inc. Deposits are payable by cash, check, debit, or credit card. Charge account customers will be handled on a case-by-case basis. Price increases outside of our control such as tariffs, pandemics, regulatory changes, material shortages, market volatility, etc., may affect pricing on quotes/estimates. Requested changes or cancellations may not be accepted and, if approved, may result in additional charges.

Date of Acceptance _____

Thank you for the opportunity and we appreciate your business.

FIBERGLASS DOORS

Commercial Fiberglass Doors

Doors in stock from 2/6 x 6/8 - 3/0 x 7/0.

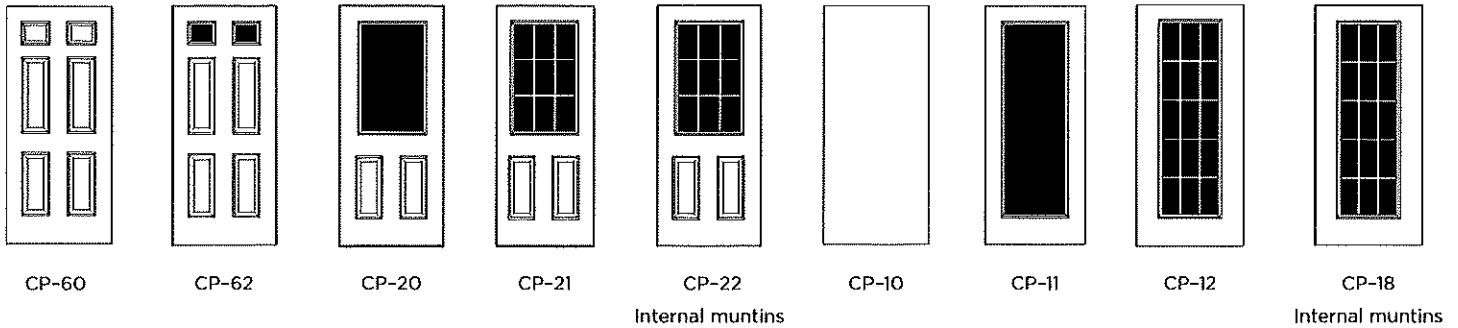

Doors available prehung or machined for De La Fontaine frame or other metal frame manufacturers.

Image shown to right:
7/0 structure with double closure block and panic bar
6/8 structure is similar, stiles are 3.175" total

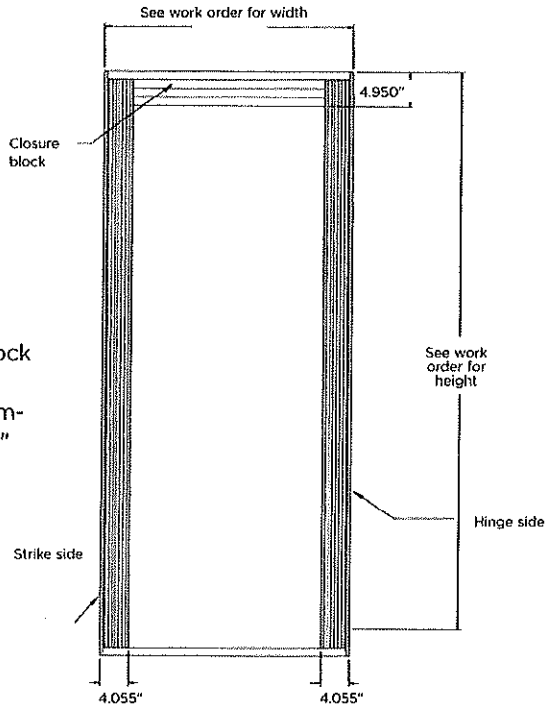

Sidelites

Align with commercial fiberglass doors above.
In stock from 1/0 x 6/8 - 1/2 x 7/0.

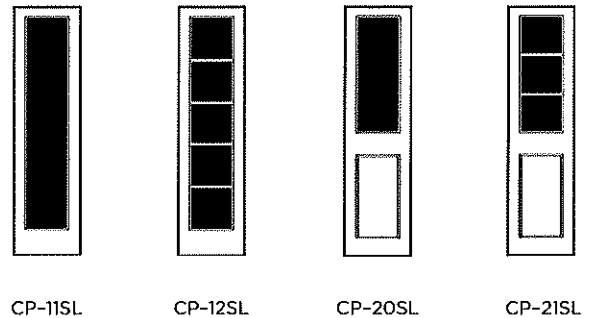

Flush Bead Glaze

In stock from 3/0 x 6/8, 3/0 x 7/0 and 3/0 x 8/0
SDL's available for flush glazed and lplight frames

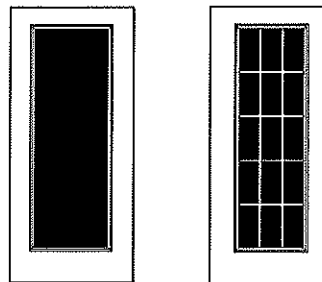

CPFG-11
ADA **

CPFG-18
ADA **

- PVC SDL's are available in a wide range of configurations. Call for pricing.
- The full view flush bead doors (CPFG-11, CPFG-18) are stocked open without glass for your choice of glass type/layout.
- 5/8" insulated glass blocked for commercial hardware

** ADA Compliant bottom rail 10-1/2"



Prehung doors available with Adaptive Sill brings an end to leaks and repairs

1. Between the base of the jamb and edge of the sill
2. At the weathertrip
3. Beneath the sill

